

PARCEL 105-WD
JOYCE AVENUE AND 17th AVENUE IMPROVEMENTS
IN THE NAME AND FOR THE USE OF THE CITY OF COLUMBUS

Situated in the State of Ohio, County of Franklin, City of Columbus and being in Quarter Township 4, Township 1, Range 18 of the United States Military Lands and being part of a tract of land conveyed to Renatha Mitchell by deed of record in Instrument # 200206120145871(all references to the Recorder's Office, Franklin County, Ohio) also part of lot 200 of Lindale Addition Subdivision in Plat Book 16, Page 37 and being a parcel of land located on the right side of the centerline of construction for Joyce Avenue and the north side of the centerline of 16th Avenue, made for the City of Columbus by Dynotec, Inc., and recorded in Plat Book _____, Page _____, and being further bounded and described as follows:

Beginning at an iron pin set at the intersection of the easterly right of way of Joyce Avenue (60' RW) and the northerly right of way of 16th Avenue (50' RW), said point being the grantor's southwest corner and the southwest corner of the said lot 200 and being 30.00 feet right of station 72+30.29 on Joyce Avenue;

Thence N 3°49'48" E along the easterly right of way of Joyce Avenue and the west line of the said lot 200 a distance of 23.71 feet to an iron pin set, being 30.00 feet right of station 72+54.00;

Thence S 39°06'08" E across the grantor's tract a distance of 32.30 feet to an iron pin set on the northerly right of way of 16th Avenue and the south line of the said lot 200, and being 52.00 feet right of station 72+30.35;

Thence N 86°20'13" W along the said right of way of 16th Avenue and the south line of the said lot 200 a distance of 22.00 feet to the point of beginning.

The above described area is contained within the Franklin County Auditor's Parcel Numbers 010-108640. Within said boundary is 0.006 acres, more or less, of which 0.000 acres is in the present road occupied, for a net take of 0.006 acres, more or less.

This description and survey was prepared from field observations made in March 2009 and reviewed on July 10, 2012 by Robert A. Bosworth, Registered Surveyor #7750.

All iron pins set are 5/8" rebar (30" long) with a yellow plastic cap stamped "R/W DYNOTEC, INC" and are to be placed at the completion of construction by the City of Columbus Survey Department.

The basis of bearings in this description is based on GPS observations using the Ohio CORS Network (Ohio South Zone) to determine a grid bearing in the NAD83 (96CORS adjustment) state plane coordinate system. The Columbus, Mount Vernon, and McConnelville CORS stations were used in determining the grid bearing, and establishing a bearing along the centerline of Joyce Avenue to be N 13°32'54"E (north of 17th Avenue).

All station and offset are referenced to the centerline of right-of-way and construction as filed with the City of Columbus and designated as "2768-DR E".

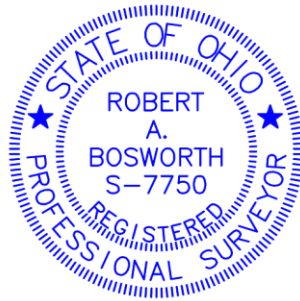

Robert A. Bosworth, P.S.
Reg. Surveyor No. 7750

Date