

**PARCEL 109-WD**  
**JOYCE AVENUE AND 17<sup>th</sup> AVENUE IMPROVEMENTS**  
**IN THE NAME AND FOR THE USE OF THE CITY OF COLUMBUS**

Situated in the State of Ohio, County of Franklin, City of Columbus and being in Quarter Township 4, Township 1, Range 18 of the United States Military Lands, being part of Lot C of the Windsor Atcheson Partition of record in Plat Book 3, Page 268 and being part of a tract of land conveyed to Rickly Hydrological Service Ltd. by deed of record in Instrument # 200001100006726 (all references to the Recorder's Office, Franklin County, Ohio) and being a parcel of land located on the right side of the centerline of construction for Joyce Avenue made for the City of Columbus by Dynotec, Inc., and recorded in Plat Book \_\_\_\_\_, Page \_\_\_\_\_, and being further bounded and described as follows:

*Commencing for reference* at a railroad spike found at the intersection of the centerline of Joyce Avenue (60' RW) and the centerline of 17th Avenue (60' RW), being at station 78+16.60 on Joyce Avenue;

Thence N 13°32'54" E along said centerline of Joyce Avenue a distance of 523.97 feet a railroad spike set at the northwest corner of a tract of land conveyed to New Generation Church by deed of record in Instrument #199812240332161 at Joyce Avenue centerline at station 83+40.57 and being the **True Point of Beginning**;

thence N 13°32'54" E along said centerline of Joyce Avenue a distance of 231.81 feet a railroad spike set at the southwest corner of a tract of land conveyed to Carolina Freight Carriers Corp. by deed of record in OR 10290 E18, said point being at station 85+72.38;

thence S 86°39'50" E along the south line of the said Carolina Freight Carriers Corp. tract a distance of 37.09 feet to an iron pin set, being 36.50 feet right of station 85+78.96;

thence S 13°32'54" W a distance of 238.57 feet to an iron pin set on the north line of the said New Generation Church, being 36.50 feet right of station 83+40.39;

thence N 76°10'04" W along the north line of the said church tract a distance of 36.50 feet to the **True Point of Beginning**.

The above described area is contained within the Franklin County Auditor's Parcel Numbers 010-133365. Within said boundary is 0.198 acres, more or less, of which 0.162 acres is in the present road occupied, for a net take of 0.036 acres, more or less.

This description and survey was prepared and reviewed on July 13, 2012 by Robert A. Bosworth, Registered Surveyor #7750.

All iron pins set are 5/8" rebar (30" long) with a yellow plastic cap stamped "R/W DYNOTEC, INC" and are to be placed at the completion of construction by the City of Columbus Survey Department.

The basis of bearings in this description is based on GPS observations using the Ohio CORS Network (Ohio South Zone) to determine a grid bearing in the NAD83 (96CORS adjustment) state plane coordinate system. The Columbus, Mount Vernon, and McConnelsville CORS stations were used in determining the grid bearing, and establishing a bearing along the centerline of Joyce Avenue to be S 86°12'13"E (north of 17<sup>th</sup> Avenue).

All station and offset are referenced to the centerline of right-of-way and construction as filed with the City of Columbus and designated as “2768-DR E”.

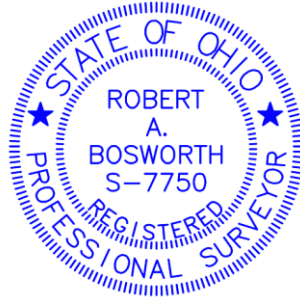

---

Robert A. Bosworth, P.S.  
Reg. Surveyor No. 7750

---

Date