

PARCEL 111-WD
JOYCE AVENUE AND 17th AVENUE IMPROVEMENTS
IN THE NAME AND FOR THE USE OF THE CITY OF COLUMBUS

Situated in the State of Ohio, County of Franklin, City of Columbus and being in Quarter Township 4, Township 1, Range 18 of the United States Military Lands, being part of Lot C of the Windsor Atcheson Partition of record in Plat Book 3, Page 268 and being part of a tract of land conveyed to Carolina Freight Carriers Corp. (Grantor) by deed of record in OR 10290 E18 all references to the Recorder's Office, Franklin County, Ohio, and being a parcel of land located on the right side of the centerline of construction for Joyce Avenue, made for the City of Columbus by Dynotec, Inc., and recorded in Plat Book _____, Page _____, and being further bounded and described as follows:

Commencing for reference at the intersection of the centerline of Joyce Avenue (60' RW) and the centerline of 17th Avenue (60' RW), being at station 78+16.60 on Joyce Avenue;

Thence N 13°32'54" E along said centerline of Joyce Avenue a distance of 755.78 feet to a railroad spike set at the southwest corner of said Grantor's land, the true point of beginning and being centerline station 85+72.38;

Thence N 13°32'54" E a distance of 250.22 feet to a railroad spike set on the centerline line of Joyce Avenue and a corner common to said Grantor's land and a tract of land conveyed to Norse Dairy Systems LLC by deed of record in Instrument # 200803210043190, being centerline station 88+22.61;

Thence S 86°37'22" E a distance of 30.48 feet along a line common to said Grantor and said Norse Dairy Systems LLC to an iron pin set on the existing eastern right of way line of Joyce Avenue, being 30.00 feet right of station 88+27.99;

Thence S 13°32'54" W a distance of 84.49 feet along said right of way line through said Grantor's land to an iron pin set at a corner for the proposed eastern right of way line of Joyce Avenue, being 30.00 feet right of station 87+43.50;

Thence S 02°14'18" W a distance of 33.14 feet along a line common to said Grantor and said proposed right of way line to an iron pin set, and being 36.50 feet right of station 87+11.02;

Thence S 13°32'54" W a distance of 132.04 feet along said common line to an iron pin set on a line common to a tract of land conveyed to Rickly Hydrological Services LTD by deed of record in Instrument # 20000110006726, being 36.50 feet right of station 85+78.96;

Thence N 86°39'50" W a distance of 37.09 feet along said common line to the point of beginning.

The above described area is contained within the Franklin County Auditor's Parcel Numbers 010-027081. Within said boundary is 0.194 acres, more or less, of which 0.172 acres is in the present road occupied, for a net take of 0.022 acres, more or less.

This description and survey was prepared and reviewed on July 13, 2012 by Robert A. Bosworth, Registered Surveyor #7750.

All iron pins set are 5/8" rebar (30" long) with a yellow plastic cap stamped "R/W DYNOTEC, INC" and are to be placed at the completion of construction by the City of Columbus Survey Department.

The basis of bearings in this description is based on GPS observations using the Ohio CORS Network (Ohio South Zone) to determine a grid bearing in the NAD83 (96CORS adjustment) state plane coordinate system. The Columbus, Mount Vernon, and McConnelville CORS stations were used in determining the grid bearing, and establishing a bearing along the centerline of Joyce Avenue to be S 86°12'13"E (north of 17th Avenue).

All station and offset are referenced to the centerline of right-of-way and construction as filed with the City of Columbus and designated as "2768-DR E".

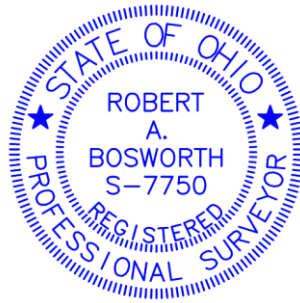

Robert A. Bosworth, P.S.
Reg. Surveyor No. 7750

Date