

ANNEXATION AN15-008 **+ 8.948 acres / Hamilton and Madison Townships** **Columbus Regional Airport Authority**

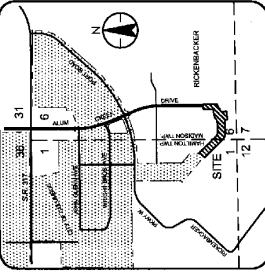

VICINITY MAP
(NOT TO SCALE)

LEGEND

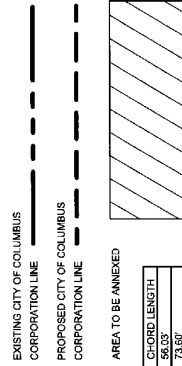

**ANNEXATION OF
8.948 ACRES**
Lying in
in Hamilton & Madison Townships, Ohio
Section 1, Township 3 North, Range 22 West
Section 6, Township 10 North, Range 21 West
Congress Lands
to City of Columbus, Ohio
Scale: 1 inch = 300 Feet

GENERAL NOTES:

1. This exhibit is intended to be used as an Expedited Type II Annexation with a total perimeter of 3997.87 feet, a length of contiguity of 218.00 feet and a 5.4 percent contiguity with the existing City of Columbus corporation line.
2. The proposed annexation does not create any islands that would be surrounded on all sides by an existing corporation line while the location of said tract would remain in said township.
3. This exhibit was prepared from deed information of record of the Recorder's Office, Franklin County, Ohio, and represents only the territory to be annexed to the City of Columbus and not for transfer of real property.

ANNEXATION CONTIGUITY:

TOTAL PERIMETER: 3997.87 feet
 LENGTH OF CONTIGUITY: 218.00 feet
 PERCENT CONTIGUITY: 5.4 %

CURVE	DELTA ANGLE	RADIUS	ARC LENGTH	CHORD BEARING	CHORD LENGTH
C1	34°14'38"	326.00'	94.12'	N 78°37'50" E	73.60'
C2	34°14'38"	326.00'	94.12'	N 78°37'50" E	73.60'

LINE	BEARING	DISTANCE
L1	N 85°09'55" W	145.22'
L2	N 85°09'55" W	282.50'
L3	N 85°09'55" W	282.50'
L4	N 85°09'55" W	282.50'
L5	N 85°09'55" W	282.50'
L6	N 85°09'55" W	282.50'
L7	N 85°09'55" W	282.50'
L8	N 85°09'55" W	282.50'
L9	N 85°09'55" W	282.50'
L10	N 85°09'55" W	282.50'
L11	N 85°09'55" W	282.50'
L12	N 85°09'55" W	282.50'
L13	N 85°09'55" W	282.50'
L14	N 85°09'55" W	282.50'
L15	N 85°09'55" W	282.50'

RECEIVED

ANNEXATION
 PLAT & DESCRIPTION
 ACCEPTABLE
 DEAN C. RINGLE, P.E., P.S.
 FRANKLIN COUNTY ENGINEER

By BB Date 7/14/15

JUL 16 2015

Franklin County Engineer
 Dean C. Ringle, P.E., P.S.

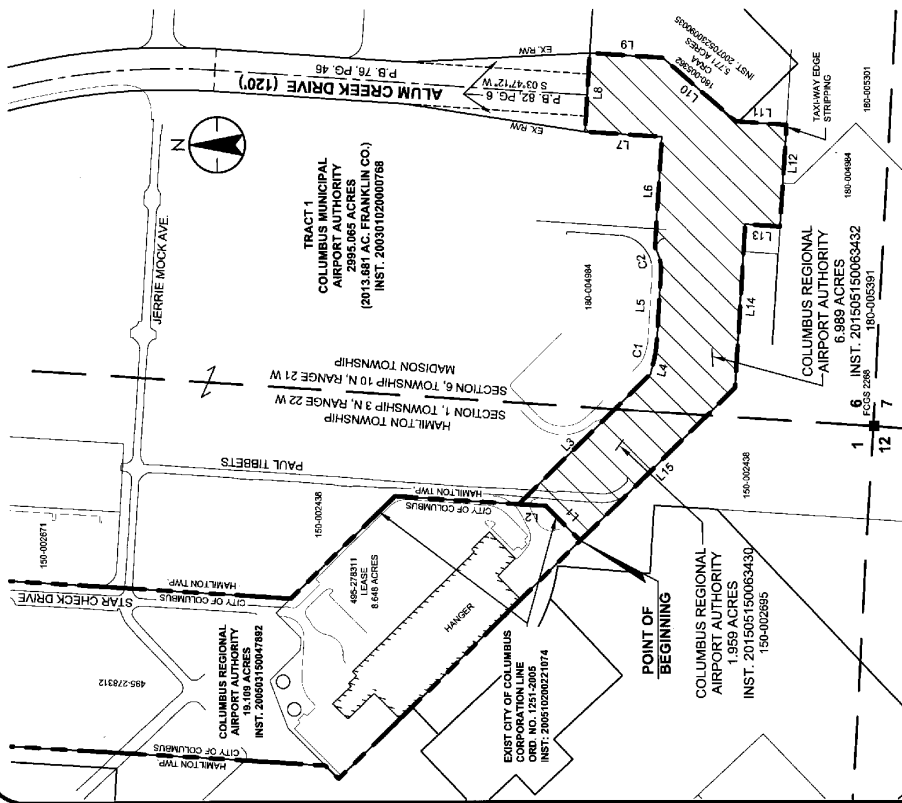

Prepared by:
Stantec
 1600 Lake Shore Drive
 Columbus, Ohio 43260
 Phone: (614) 486-4385
 Fax: (614) 486-4387

Copyright © 2015 Stantec. All rights reserved. No part of this drawing may be reproduced or transmitted in any form or by any means electronic or mechanical, including photocopying and recording, or by any information storage or retrieval system, without permission in writing from Stantec. Stantec is not responsible for any errors or omissions in this drawing. Stantec is not a surveyor and does not warrant the accuracy of the information provided in this drawing.