

**RECEIVED**  
NOV 08 2018  
Franklin County Engineer  
Cornell R. Robertson, P.E., P.S.

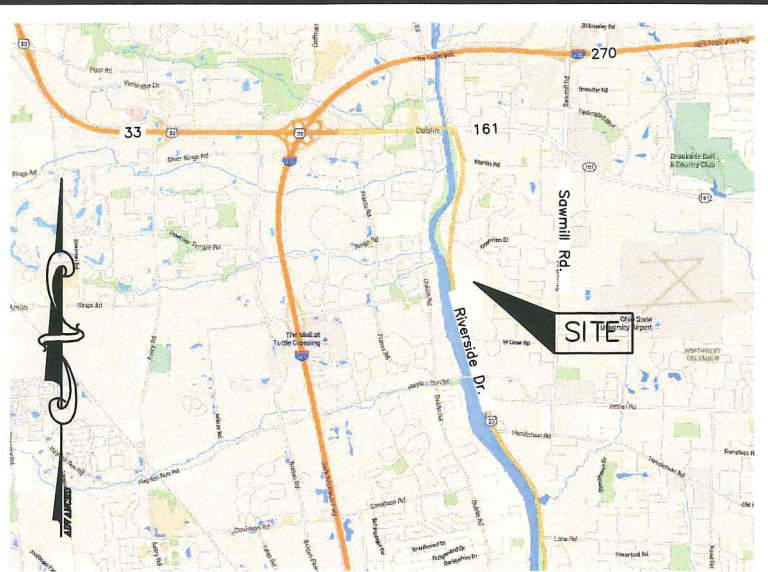

**LOCATION MAP**  
No Scale

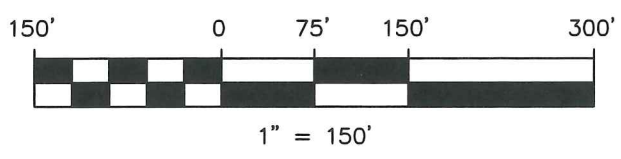



**2.715± Ac.**

Length of Contiguity: ±730.2 feet  
Total Length of Perimeter: ±1463.3 feet  
Percentage of Contiguity : ±49.9%

No islands of township property are created by this annexation.

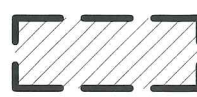

**Legend**

-  Area to be Annexed
-  Existing City of Columbus Corp Line
-  Proposed City of Columbus Corp Line

**2.715± ACRE ANNEXATION FROM THE TOWNSHIP OF PERRY TO THE CITY OF COLUMBUS**

Township of Perry,  
Franklin County, Ohio  
Quarter Township 3, Township 2  
Range 19, U.S.M.L.

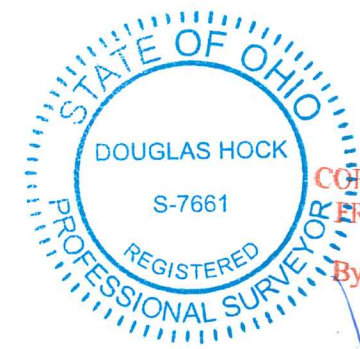

**ANNEXATION PLAT & DESCRIPTION ACCEPTABLE**  
CORNELL R. ROBERTSON, P.E., P.S.  
FRANKLIN COUNTY ENGINEER

By KAR Date 11/8/18

Douglas R. Hock, P.S. 7661 Date: 11/7/18  
Advanced Civil Design, Inc  
422 Beecher Road  
Gahanna, OH 43230  
Phone 614-428-7750  
Job No.: 17-0027-149  
Date: 11/7/2018

