

CITY FORESTRY NOTE:
 TWO-YEAR WARRANTY SHALL BE IN EFFECT FOR THE TREES LOCATED ON THE FIRE STATION PARCEL PID 0101-243356 AT 5433 FISHER ROAD. IF THE RESULTING WORK DIMINISHES THE INTEGRITY, AESTHETICS, OR VALUE OF THE TREE, BUT NOT TO THE EXTENT WHERE IT IS DEEMED NECESSARY TO REMOVE THE TREE. VALUE OF SAID TREE WILL BE ASSESSED BY CITY FORESTRY AND THE VALUE LOST FROM THE DAMAGE WILL BE PAID BY THE PERMIT HOLDER INTO THE CITY FORESTRY TREE FUND.

- CONTRACTOR TO POT HOLE AREA PRIOR TO BORING
- WATER LINE NOTE:**
 EXPOSE ALL WATER LINES AT CROSSINGS TO VERIFY ACTUAL DEPTH AND LOCATION PRIOR TO AND DURING CONSTRUCTION.

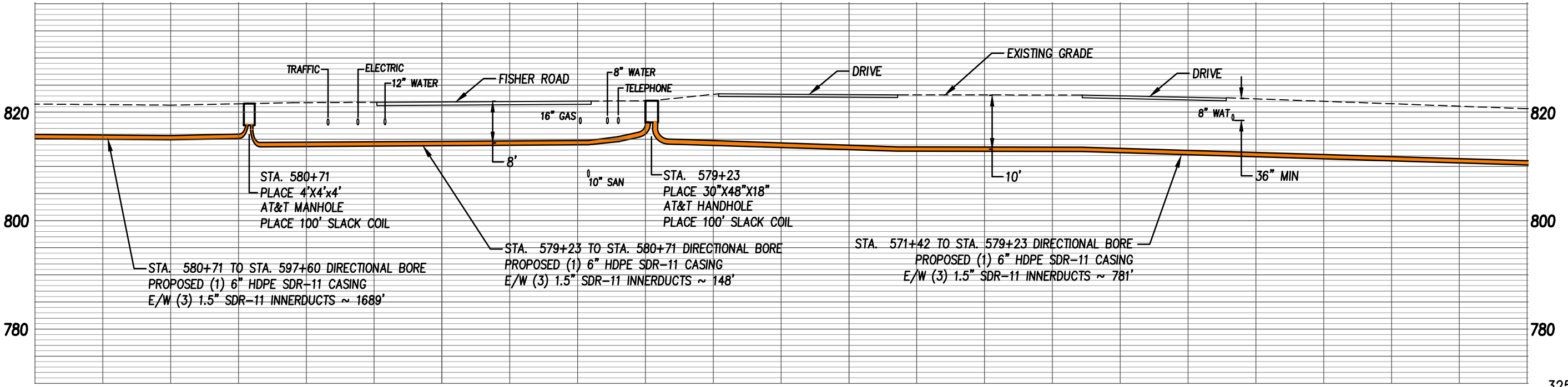

REVISIONS:
 1. REVISIONS TO RELOCATE AT STA. 597+60. 04-17-20

- NOTES:**
- CONSTRUCTION ISSUE 9-24-19
 - CONSTRUCTION NO. 530086-100027 PROJECT NO. 3258-E
 - AT&T RELOCATION DUE TO C.O.C. PID NO. 98557 HILLIARD AND ROME RD IMPROVEMENTS
 - CONTRACTOR SHALL REPLACE ALL DRIVEWAYS, SIDEWALKS, OR OTHER DISTURBED SURFACES TO A CONDITION EQUAL TO OR BETTER THAN THE PRIOR EXISTING CONDITIONS.
 - EXISTING UTILITIES SHOWN ARE APPROXIMATE. CONTRACTOR SHALL BE RESPONSIBLE FOR LOCATING AND POT-HOLING ALL WATER, GAS, CABLE, CABLE TV AND ELECTRIC SERVICES PRIOR TO BEGINNING ANY EXCAVATION.
 - PROPERTY AND RIGHT OF WAY BOUNDARIES SHOWN ON THIS DRAWING ARE APPROXIMATE. SHOULD NOT BE RELIED UPON TO ESTABLISH EASEMENT RIGHTS OR FEE OWNERSHIP.

2 WORKING DAYS BEFORE YOU DIG CALL TOLL FREE 800-362-2764

AT&T PROPRIETARY (RESTRICTED) SOLELY FOR AUTHORIZED PERSONS HAVING NEED TO KNOW PURSUANT TO COMPANY INSTRUCTIONS



PREPARED FOR RECORD
 APPROVED FOR: MIKE DIEDERICH ENGINEER DATE
 I HEREBY CERTIFY THAT THIS DOCUMENT WAS PREPARED BY ME OR UNDER MY DIRECT SUPERVISION AND THAT I AM A DULY REGISTERED ENGINEER UNDER THE LAWS OF THE STATE OF OHIO.
 SIGNED DATE: REG. NO.

 910 Camaro Run Drive, West Chester, PA 19380
 Office: (610) 696-6910 • Fax: (610) 696-6937

PROPRIETARY
 USE PURSUANT TO COMPANY INSTRUCTIONS
 SPECIFICATION
 PROJECT NUMBER A0132ZF
 OWNERSHIP: 100%
 LINE CODE: CLMBOHU0112
 CABLE CLLI: CLMBOHU0112
 SCALE: HORIZONTAL 1" = 40'
 VERTICAL 1" = 20'
 COLUMBUS, OHIO TO DAYTON, OHIO LIGHTGUIDE SYSTEM
 COLUMBUS - DAYTON FTA CABLE PROPOSED RELOCATION FISHER ROAD IMPROVEMENTS PLAN AND PROFILE